

M.2 (P110) 4IG2-P series

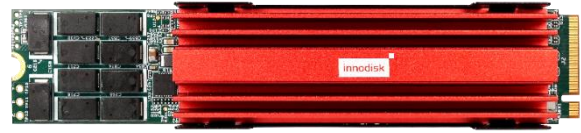

Diagram (ST)

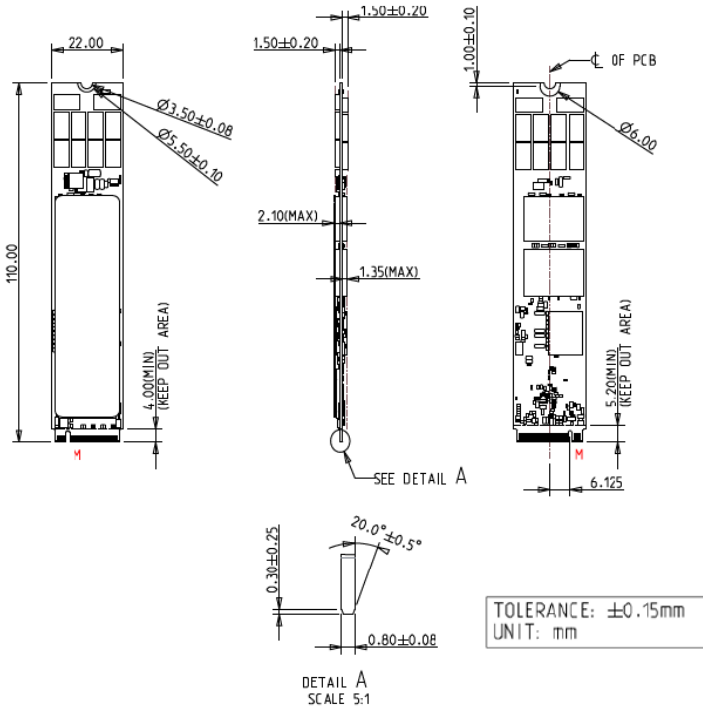
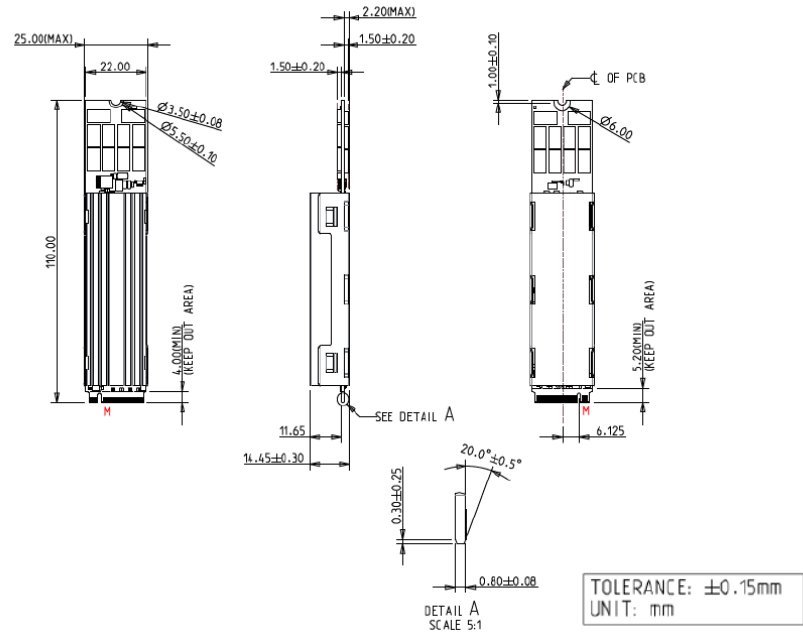

Diagram (WT)



Specifications

Interface	PCIe Gen. 4x4
Flash Type	iSLC (3D TLC)
P/E cycle	100,000
Capacity	160GB~1.28TB
Max. Channels	8
Sequential R/W (MB/sec, max.)	7,050/5,250
Max. Power Consumption	10.2W
Thermal Sensor	√
External DRAM buffer	√
H/W Write Protect	NA
Dimension (WxLxH)	ST with heat-spreading copper layer: 22.0 X 110.0 X 4.5 mm WT with heatsink: 25 X 110.0 X 14.45 mm (Pure M.2: 22.0 X 110.0 X 4.0 mm)
Environment	Vibration: 20G @7~2000Hz Shock: 1500G @ 0.5ms Storage Temperature: -40°C ~ +85°C MTBF: 3 million hours

Ordering Information

Operation Temp.	160GB	320GB	640GB	1.28TB
Standard Grade (0°C ~ +70°C)	DHM21-A60DP1KCBELP	DHM21-D2GDP1KCBFLP	DHM21-F4GDP1KCBELP	DHM21-1T2DP1KCBEPQ
Industrial Grade (-40°C ~ +85°C)	DHM21- A60DP1KWBELPH	DHM21-D2GDP1KWBELPH	DHM21-F4GDP1KWBELPH	DHM21-1T2DP1KWBEPQ